

TUE-100

CNC Vertical Boring and Turning Mills



Machine Specifications			TUE-100 / TUE-100(S)	
Travel	X-axis travel (Horizontal travel of Ram)	mm [in]	-510 ~ 750 [-20.1 ~ 28.5]	
	Z-axis travel (Vertical travel of Ram)	mm [in]	800 [31.5]	
Table	Table diameter	mm [in]	1 016 [40.0]	
	Maximum swing size	mm [in]	1 200 [47.24]	
	Table speed	min-1	2 to 600	
	Table loading capacity	kg [lbs]	2 000 [4 400]	
Spindle	Spindle speed	min-1	15 to 3 000	
	Maximum torque	Nm [lbf-ft]	223 [171.8]	
Feedrate	Rapid traverse rate	X	mm/min [ipm]	15 000 [590.55]
		Z	mm/min [ipm]	12 000 [472.4]
		C	deg/min	720
	Feedrate	X, Z	mm/min [ipm]	2 000 [78.74]
C		deg/min	360	
Motor	Table drive (30/Cont.)	kW [HP]	AC45/37 [AC60/50]	
	Spindle drive (30/Cont.)	kW [HP]	AC18.5/15 [AC24.6/20]	
Machine size	Height x Width x Depth	mm	4880 x 5080 x 4350	
		in	192.1 x 200.0 x 171.3	

Shibaura Machine

755 Greenleaf Avenue | Elk Grove Village, IL 60007 | mt-sales@shibaura-machine.com

Option Accessories

Auto Tool Tip Measurement



Auto Work Measurement



Half size cover



Machine General Views

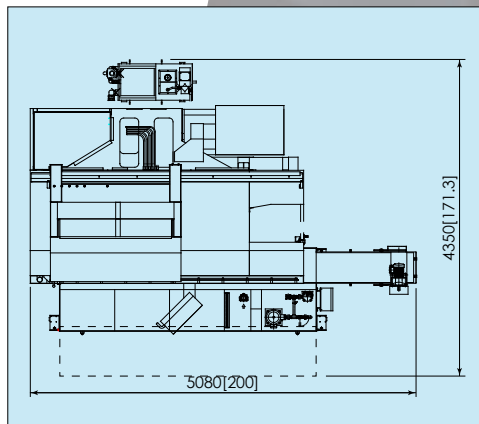
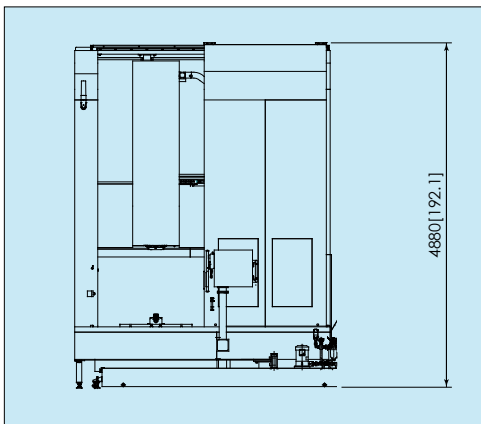

Machine Accessories

FANUC 0i-MODEL F
Individually 4 Jaws chuck
Double Face Contact spindle
Auto power shut down
Auto diameter and Step measurement
Full Closed cover
X axis scale feedback
Manual guide i (OP)

Number of Auto Tool Change : 18(S type) 12(Non S type)
FMS50A CAT50
2Mpa[284PSI] CTS
Auto measurement function
Auto Tool Tip measurement
Table center hole and tap

Shibaura Machine

755 Greenleaf Avenue | Elk Grove Village, IL 60007 | mt-sales@shibaura-machine.com
<https://www.shibaura-machine.com/>